

HOW TO MEASURE & PHOTOGRAPH YOUR SPACE

This guide will help you to provide me the following information...

- ♥ Floor Plan
- ♥ Elevations
- ♥ Take Photos

When you do all these things, you can send the floor plan/elevation and photos to me. You can do this via email or messenger.

support@urallasolutions.com

HOW TO DRAW YOUR SPACE

1. Use a pencil, sketch out the existing layout & be sure to include the locations of all windows, doors, and closets.

2. Use a tape measure to measure each wall, corner to corner. It's easier to hold the tape measure on the floor to measure.

3. Write down the sizes and locations (and heights if applicable) of each window, door, doorway, closet, electrical, media outlets, ceiling and wall fixtures including... a pass-thru, built-in bookcases, any heaters, closets, alcoves, or wall projections (nbn boxes), etc.

4. Measure and write down the ceiling height.



5. Now, measure each window from the floor to the bottom of the window, and again from the floor to the top of the window. Then measure the width of the window and write down all those measurements.

When you finish the first wall, total the measurement; it should match the first overall measurement. Continue this process around the room, and note the measurements on your drawing.

Other stuff that would be helpful for me to know:

- ♥ Ceiling height for each room
- ♥ Location of all power outlets
- ♥ Height and widths of windows and doors
- ♥ Location of windows on each wall
- ♥ Location of any wall sconces and/or ceiling lights

*When drawing in pencil, please make sure the lines are dark enough so when you later scan your drawings back to me I will be able to read them easily.



How to Draw Your Room

{Step One} Draw Floorplan

Get a pencil. Get a piece of paper. Sketch your room.

Label each wall as either North, South, East West. Don't know which is which? The sun rises in the East and sets in the West.

Now that you got the shape of the room, measure it in metres and cm

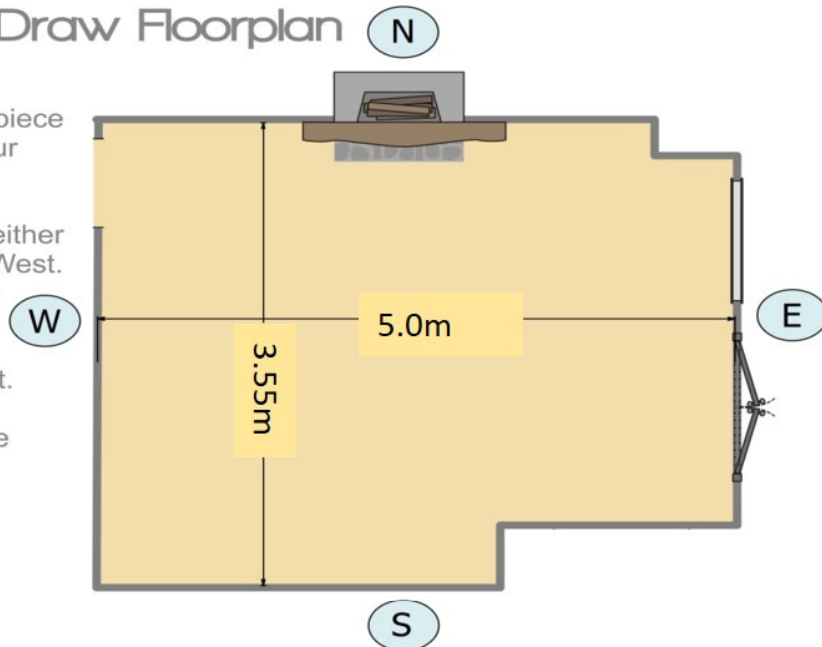

{Step Two} Draw Walls

Draw a rectangle for your wall. Measure each wall in metres and cm

Write in the height and width of the wall.

Let me know if it is the North, South, East or West wall.

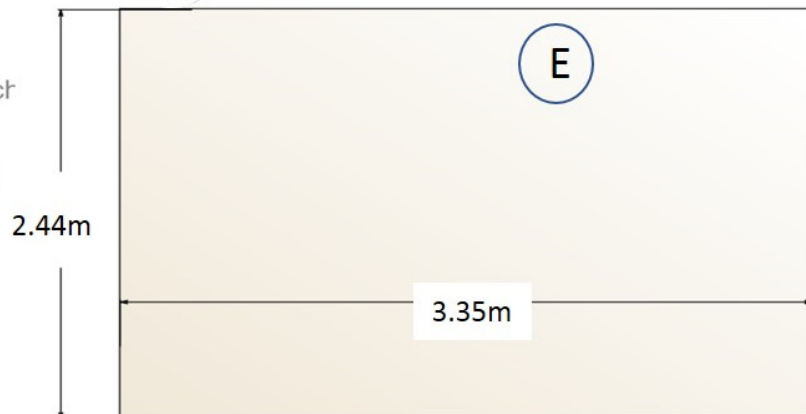

Please repeat steps 2, 3, and 4 for each wall.



How to Draw Your Room

{Step Three} Draw Features

Draw the features like windows, doors and fireplaces. You need to measure each section of wall and placement of features.

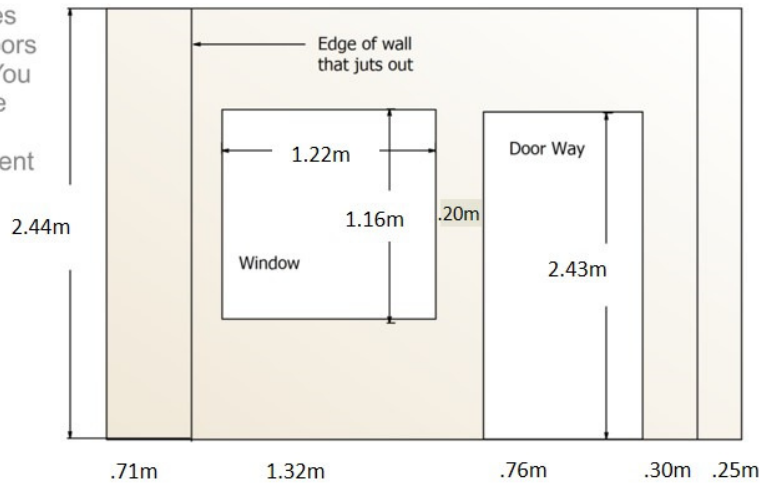

{Step Four} Draw all the other bits

Draw the small things that are important like light switches, sconces, outlets, wall vents, etc.

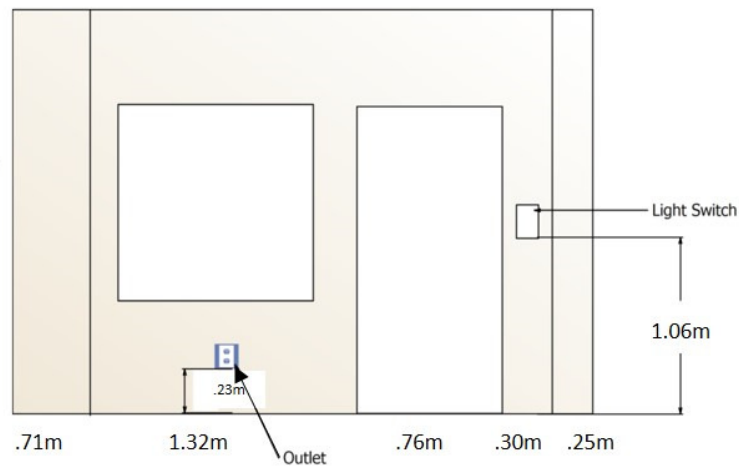

Please repeat steps 2, 3, and 4 for each wall.



How to Photograph Your Room

Tips

- {1} Take photos during the day
- {2} Turn on all the lights
- {3} Remove clutter & crap
- {4} Try taking photo first without the flash
- {5} Try turning the camera vertically
- {6} Try standing on a chair
- {7} Try a shot of tequila
- {8} Send your best photos

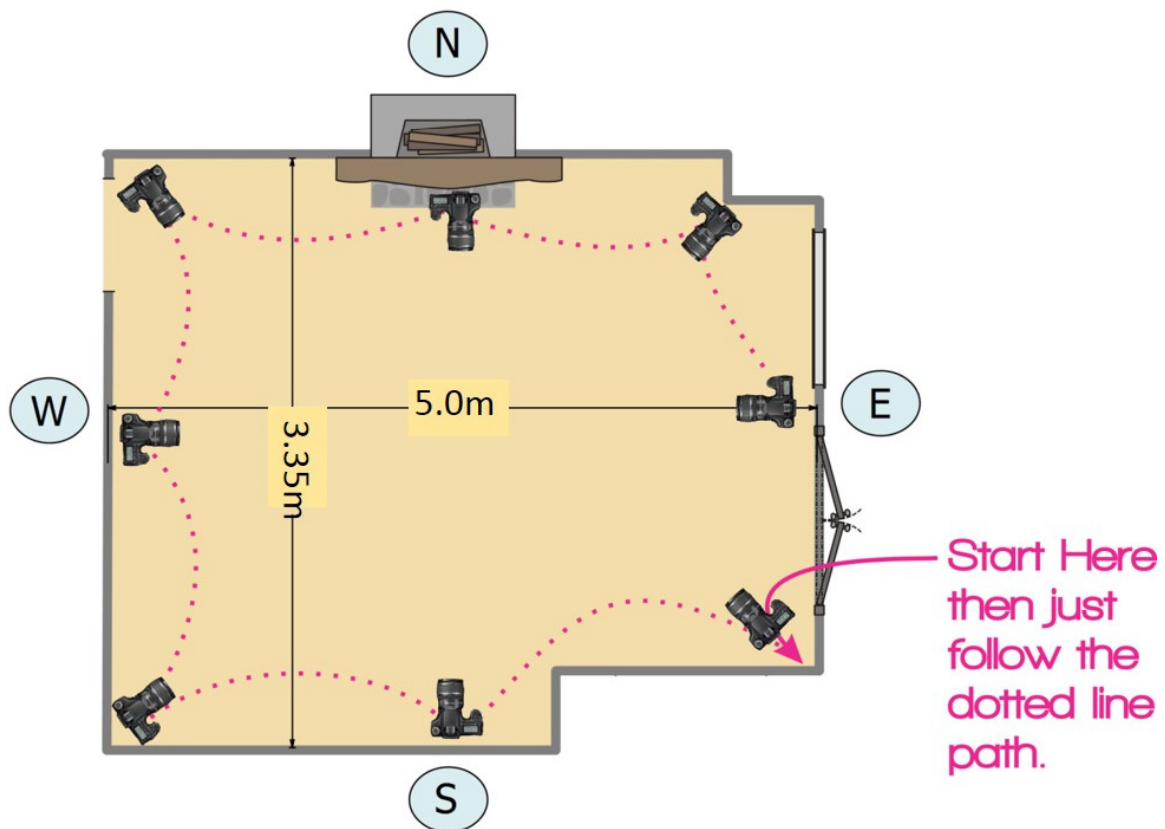

Please try to keep people (and clutter, if possible) out of the shot.

See the last page for photo taking tips.



GRAPH PAPER PAGE | ONE SQUARE EQUALS SIX INCHES

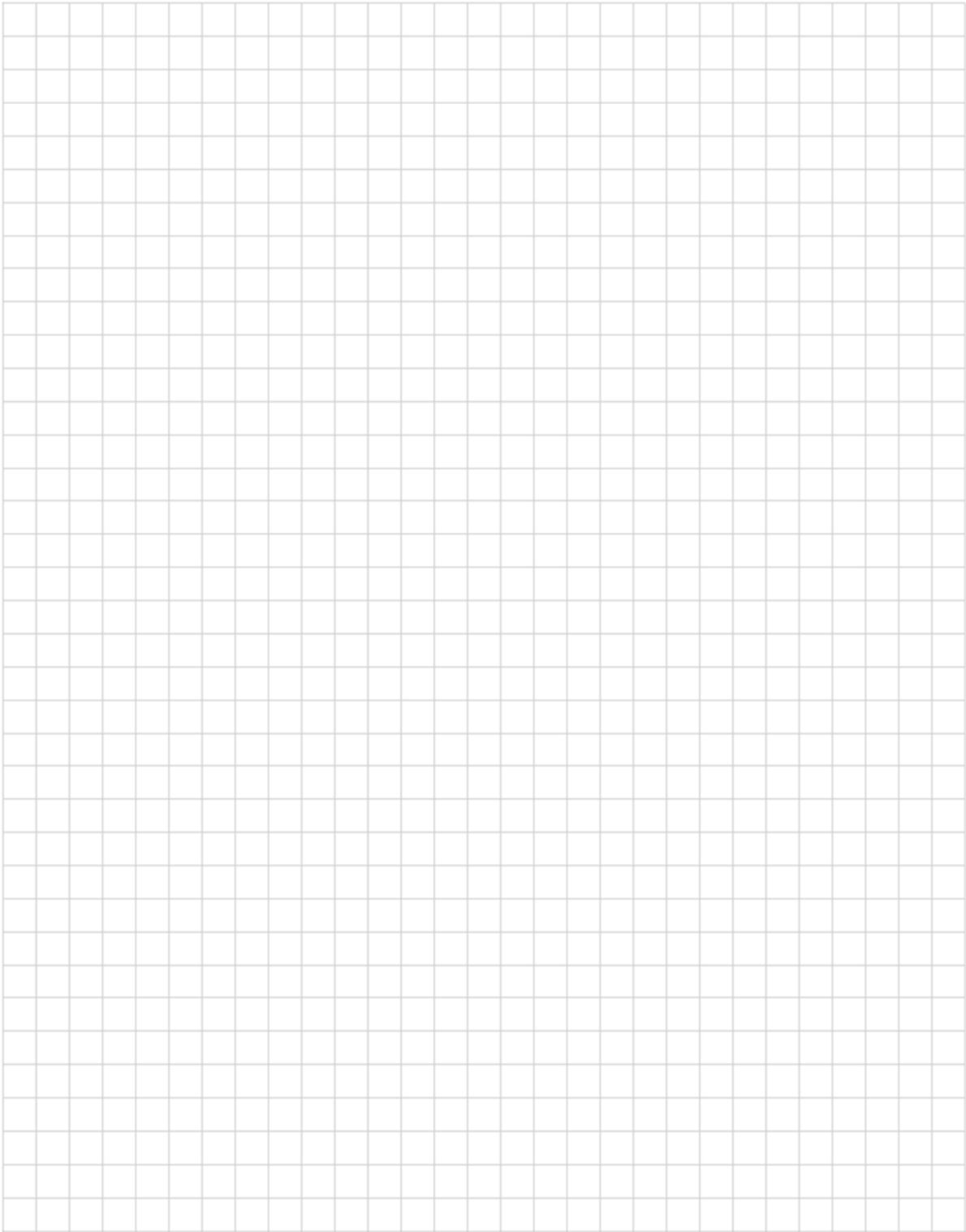

Photography Tips

- ♥ It is usually best to shoot in daylight and avoid flash — which can sometimes lend a blown-out and artificial appearance to a scene. It's nice to turn on lights in a room just for a little point of brightness. If you do use a flash, be sure not to reflect the light off glass or mirrors, because you'll get a bright streak in the image that you won't like.
- ♥ Dusk is also a better time to photograph windows — low natural light will allow you to take pictures that aren't blown out by midday sunlight.
- ♥ For interiors especially, you will find that getting on your knees often offers the best angle.
- ♥ Try not to take the photo when the sun is shining directly into the room.
- ♥ Try turning the camera vertical to get a taller shot.

Tips from Apartment Therapy and Young House Love

